

GROOVING

150°

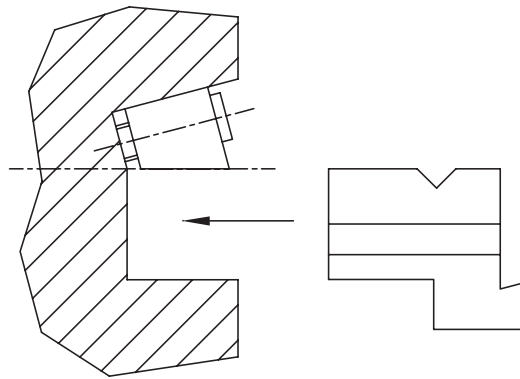



Base holder assembly instruction

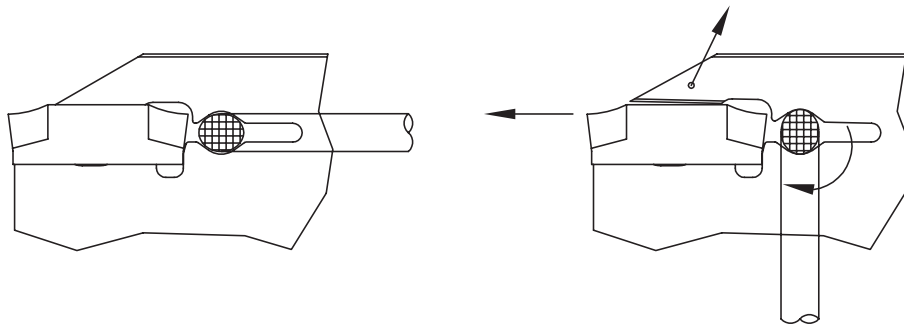

Instruction for changing the insert

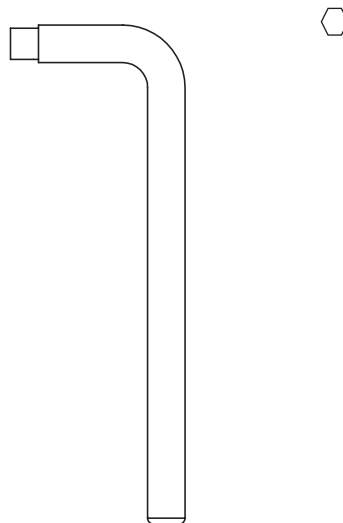

Assembly-key

BASE DI SUPPORTO _ GRUNDHALTER _ BASE HOLDER

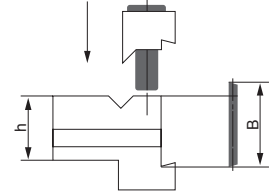
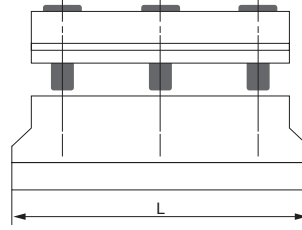

GETB	h	L (mm)	B	KG	STOCK	€
GETB 1910	10	76	19	0,200	○	292,50
GETB 1912	12	76	19	0,250	○	292,50
GETB 1916	16	76	19	0,300	○	292,50
GETB 2620	20	87	26	0,600	○	301,50
GETB 2625	25	87	26	0,700	○	322,50
GETB 3220	20	100	32	0,800	○	305,50
GETB 3225	25	110	32	1,000	○	329,00
GETB 3232	32	120	32	1,300	○	334,00

BASE VDI CON LUBRIFICAZIONE _ VDI GRUNDHALTER MIT IK _ VDI TOOL HOLDER WITH IC

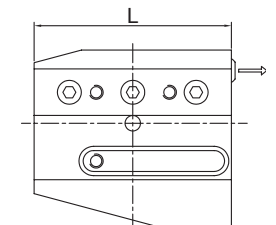
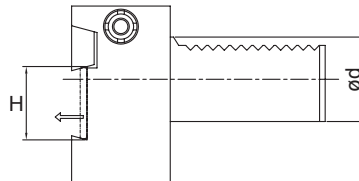

GEGB	Ø d	L (mm)	H	KG	STOCK	€
GEGB VDI30/26 COOL	30	70	26	1,300	●	1126,50
GEGB VDI30/32 COOL	30	70	32	1,300	●	1126,50
GEGB VDI40/32 COOL	40	85	32	2,150	●	1126,50

LAMA _ STECHSCHWERTER _ BLADE

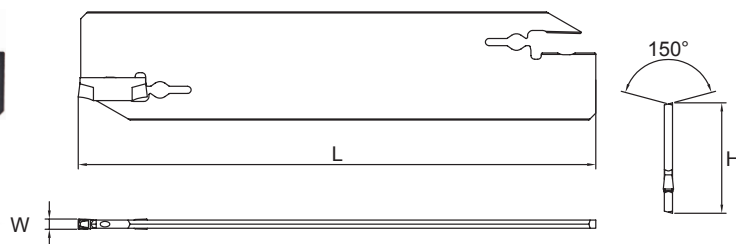

GECB

	↔ (mm)				KG	STOCK	€
	W	H	L				
GECB 1920 S	2,0	19	86		0,040	●	135,50
GECB 2620 S	2,0	26	110		0,050	●	145,50
GECB 2630 S	3,0	26	110		0,060	●	145,50
GECB 3230 S	3,0	32	150		0,090	●	163,50
GECB 2640 S	4,0	26	110		0,100	●	145,50
GECB 3240 S	4,0	32	150		0,100	●	163,50

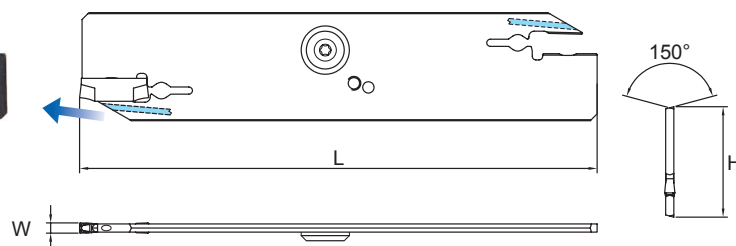

GECB COOL

	↔ (mm)						KG		STOCK	€
	W	H	L							
GECB 2620 S COOL	2,0	26	110				0,050	●	●	279,00
GECB 2630 S COOL	3,0	26	110				0,060	●	●	279,00
GECB 3230 S COOL	3,0	32	150	VT40SL	GESL	BT15	0,090	●	●	303,50
GECB 2640 S COOL	4,0	26	110				0,100	●	●	279,00
GECB 3240 S COOL	4,0	32	150				0,100	●	●	303,50

FRESE PER SCANALATURE E TAGLIO _ SCHEIBENFRÄSER _ GROOVING AND CUT OFF MILLS

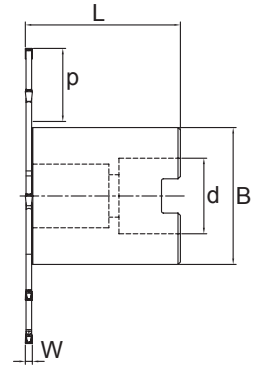
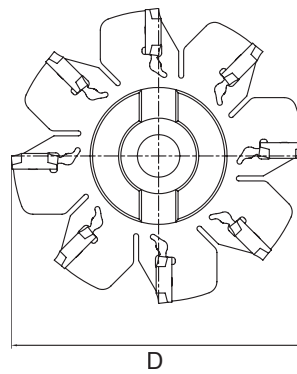

GEDM	Ø D	L	↔ (mm)			Ø B	d	Z		KG		STOCK	€
			W	p									
GEDM 08020 Z4 ST *	80	39,9	2,0	25		29	M16	4	GELCG..192002	0,250	--	●	1197,00
GEDM 10020 Z6 SA	100	51,9	2,0	28		40		6		0,700	--	●	1381,00
GEDM 12520 Z8 SA	125	51,9	2,0	36		48		8		1,250	--	●	1491,50
GEDM 16020 Z10 SA	160	64,9	2,0	39		80		10	2,500	--	●	1771,00	
GEDM 08030 Z4 ST *	80	40,7	3,0	25		29	M16	4	GELCG..193002	0,250	--	●	1222,00
GEDM 10030 Z6 SA	100	52,7	3,0	28		40		6		0,700	--	●	1404,00
GEDM 12530 Z8 SA	125	52,7	3,0	36		48		8		1,300	--	●	1526,50
GEDM 16030 Z10 SA	160	65,7	3,0	39		80		10	2,550	--	●	1802,00	
GEDM 12540 Z6 SA	125	53,5	4,0	37,5		48		6	1,350	--	●	1465,50	
GEDM 16040 Z8 SA	160	66,5	4,0	39		80		8	2,650	--	●	1665,00	

* Gambo filettato _ Schaftausführung Gewinde _ Threaded shank

INSERTI _ WECHSELPLATTEN _ INSERTS

Inserto unico per tutto il programma _ Ein Wendepatte fuer gesamtes Programm _ One insert for whole programme

CODICE ORDINE Bestell-Nr. Order No.	FIGURA Form Figure	↔ (mm)		TAGLIANTI Schneide Cutting edge	DENOMINAZIONE Bezeichnung Designation	NON RIVESTITI Unbeschichte Uncoated			RIVESTITI Beschichtet Coated				CERMET		
		W	r			K15	P25	P40	P200	P300	K300	K400	TIN PVD	TIALN PVD	X99
		2,0	0,2	1	GELCGS 192002	● 17,70				● 17,70	● 17,70				
		3,0	0,2	1	GELCGS 193002	● 18,80				● 18,80	● 18,80				
		4,0	0,2	1	GELCGS 234002	● 19,90				● 19,90	● 19,90				
		2,0	0,2	2	GELCGD 192002	● 21,00				● 21,00	● 21,00				
		3,0	0,2	2	GELCGD 193002	● 22,10				● 22,10	● 22,10				
		4,0	0,2	2	GELCGD 234002	● 23,30				● 23,30	● 23,30				

GE KEY

Chiave _ Schlüssel _ Spanner

€



Chiave non inclusa. Da ordinare separatamente.
Schlüssel nicht eingeschlossen. Separat bestellen.
Key not included. To be ordered separately.

18,30

PARAMETRI INSERTI	RICAMBI	SPEED TIGER	INSERTS	SLIM CHUCK	YES DRILLS	NICECUT	GE DRILLS	GROOVING	MINITOOOLS	MICROTOOLS AMS	MOULDMILL	MINIMILL	MILLING
----------------------	---------	-------------	---------	------------	------------	---------	-----------	----------	------------	-------------------	-----------	----------	---------



GE TOOLING S.r.l.

Via Elsa Morante, 71 - 41123 Modena
Tel. +39 059 331543 - Fax. +39 059 822617
getools@getooling.it-www.getooling.it