

SLIM CHUCK

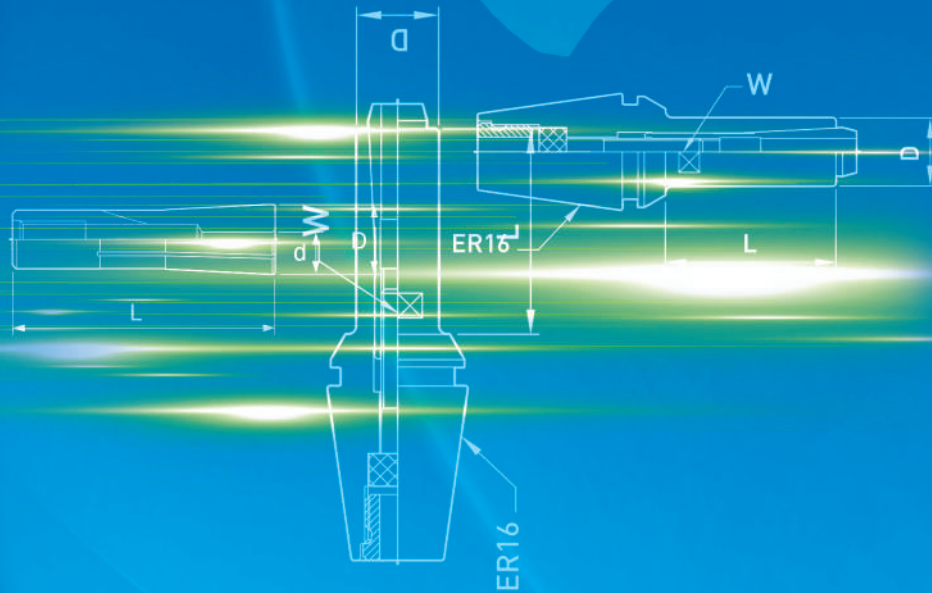

MILLING
MINIMILL
MOULDMILL
MICROTOOLS
MICROTOOLS AMS
GROOVING
GE DRILLS
NICECUT
YES DRILLS
SLIM CHUCK

MANDRINO A PINZA SLIM CHUCK SLIM CHUCK SPANNZANGENAUFNAHME _ SLIM CHUCK EXTENSION ADAPTOR



Fig. 1



Mandrino a pinza progettato senza ghiera, parte da un diametro di 8,6mm. In questo modo si raggiunge l'effetto migliore nel processo di estensione.

Spannzangenaufnahme ohne Oberwurfmutter, mindest Durchmesser 8,6mm. In dieser Weise, erreicht man den besten Effekt mit der Verlängerung.

Slim collet chuck designed without nut can get the smallest outside diameter of 8.6 mm. This can achieve the best effect on extended processing depth.

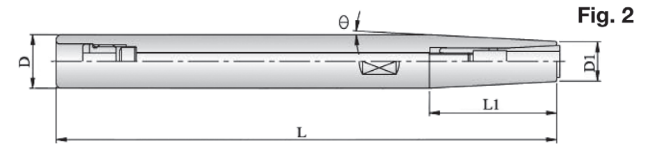
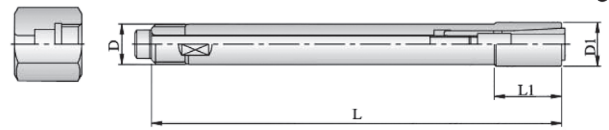

ST	Fig.	↔ (mm)					Pinza Spannzange Collet	Chiave Schlüssel Spanner	Vite Schraube Screw	Bussola Schraube Stop Screw	Estrattore Auszieher Stop Nut	STOCK	€	
		d	L	L1	D	D1								?
ST10-DC4-90	1	2-4	90	14	10	9	-	DC4	30194-632(M3)	M4L70	-	TP-M8	○	482,50
ST12-DC4-120	2	2-4	120	38	12	9	3°	DC4	30194-632(M3)	M4L85	OP-M8	-	○	539,50
ST12-DC6-120	1	1-6	120	40	12	14	-	DC6	30194-643(M4)	M5L95	-	TP-M12	○	482,50
ST16-DC6-150	2	1-6	150	35	16	14	3°	DC6	30194-643(M4)	M5L100	OP-M10	-	○	539,50
ST20-DC6-200	2	1-6	200	70	20	14	3°	DC6	30194-643(M4)	M5L100	OP-M10	-	○	673,50
ST25-DC6-250	2	1-6	250	115	25	14	3°	DC6	30194-644(M4)	M5L100	OP-M10	-	○	953,-
ST20-DC8-200	2	3-8	200	50	20	19	2°	DC8	30194-652(M5)	-	OP-M12	-	○	559,-

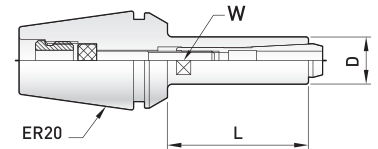
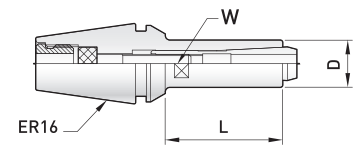

ER	d	↔ (mm)			Pinza Spannzange Collet	Chiave Schlüssel Spanner	STOCK	€
		L	D	W				
ER16-DC4-25	2-4	25	9	8	DC4	30194-632(M3)	○	370,-
ER20-DC6-35	1-6	35	14	13	DC6	30194-643(M4)	○	370,-

PINZE DC TIPO E DC SPANNZANGEN TYPE E _ DC COLLETS TYPE E

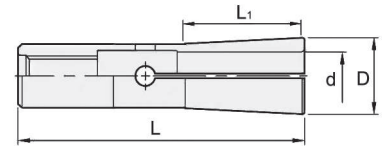

DC...E	d	L	(mm)	D	W	STOCK	€
DC4-2E	2	31		10	7	○	170,50
DC4-3E	3	31		14	7	○	151,-
DC4-4E	4	31		14	7	○	151,-
DC6-3E	3	36		14	9,6	○	151,-
DC6-4E	4	36		14	9,6	○	151,-
DC6-6E	6	36		16	9,6	○	151,-
DC8-3E	3	45		15	15	○	155,-
DC8-4E	4	45		16	15	○	155,-
DC8-6E	6	45		24	15	○	155,-
DC8-8E	8	45		26	15	○	155,-

PINZE DC TIPO K DDC SPANNZANGEN TYPE K _ DC COLLETS TYPE K

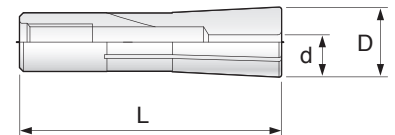

DC...K	d	(d)	(mm)	L	D	STOCK	€
DC6-1.0K	1.0	0.9 ~ 1.0		36	9,6	○	205,-
DC6-1.1K	1.1	1.0 ~ 1.1		36	9,6	○	205,-
DC6-1.2K	1.2	1.1 ~ 1.2		36	9,6	○	205,-
DC6-1.3K	1.3	1.2 ~ 1.3		36	9,6	○	205,-
DC6-1.4K	1.4	1.3 ~ 1.4		36	9,6	○	205,-
DC6-1.5K	1.5	1.4 ~ 1.5		36	9,6	○	205,-
DC6-1.6K	1.6	1.5 ~ 1.6		36	9,6	○	205,-
DC6-1.7K	1.7	1.6 ~ 1.7		36	9,6	○	205,-
DC6-1.8K	1.8	1.7 ~ 1.8		36	9,6	○	205,-
DC6-1.9K	1.9	1.8 ~ 1.9		36	9,6	○	205,-

SET DC SLIM CHUCK- MANDRINO + PINZE _ SET DC SLIM CHUCK - AUFNAHME + SPANNZANGEN
SET OF DC SLIM CHUCK EXTENSION ADAPTOR + COLLETS



DC4	Contenuto set - Inhalt des Sets - Set contents					STOCK	€
	Mandrino Aufnahme Collet Chuck	Pinza Spannzange Collet	Chiave (A) Schlüssel (A) Spanner (A)	Chiave (B) Schlüssel (B) Spanner (B)			
SST10-DC4-90	ST10-DC4-90	DC4-2E x 1 pc DC4-3E x 1 pc	30194-002	30194-632	○	865,-	
SST12-DC4-120	ST12-DC4-120	DC4-4E x 1 pc			○	943,-	

DC6	Contenuto set - Inhalt des Sets - Set contents					STOCK	€
	Mandrino Aufnahme Collet Chuck	Pinza Spannzange Collet	Chiave (A) Schlüssel (A) Spanner (A)	Chiave (B) Schlüssel (B) Spanner (B)			
SST12-DC6-120	ST12-DC6-120	DC6-3E x 1 pc DC6-4E x 1 pc	30194-002	30194-643	○	865,-	
SST16-DC6-150	ST16-DC6-150	DC6-6E x 1 pc			○	943,-	

Chiave (A) Schlüssel (A) Spanner (A)	Chiave (B) Schlüssel (B) Spanner (B)	Vite Schraube Screw	Bussola Schraube Stop Screw	Estrattore Auszieher Stop Nut
--------------------------------------	--------------------------------------	---------------------	-----------------------------	-------------------------------

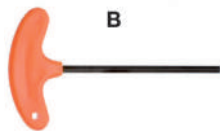
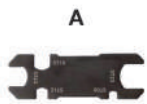

CODICE ORDINE Bestell-Nr. Order No.	CODICE ORDINE Bestell-Nr. Order No.	mm	L	CODICE ORDINE Bestell-Nr. Order No.	Filetto Gewinde Thread	L	CODICE ORDINE Bestell-Nr. Order No.	Filetto Gewinde Thread	CODICE ORDINE Bestell-Nr. Order No.	Filetto Gewinde Thread
30194-002	30194-632	3	100	M4L70	M4	70	OP-M8	M8(L)	TP-M8	M8(L)
	30194-643	4	150	M4L85	M4	85	OP-M10	M10(L)	TP-M12	M12(L)
	30194-644	4	200	M5L95	M5	95	OP-M12	M12(L)		
				M5L100	M5	100	OP-M16	M16(L)		

Il filetto della bussola è sinistro
 Die Gewinde der Schraube ist links
 Thread of stop screw is leftward

Il filetto della bussola è sinistro
 Die Gewinde der Schraube ist links
 Thread of stop screw is leftward

MILLING
MINIMILL
MOULDMILL
MICROTOOLS
MICROTOOLS AMS
GROOVING
GE DRILLS
NICECUT
YES DRILLS
SLIM CHUCK